

SW2-IP67 Series Micro Switches (WATERPROOF)

herga

Technology Ltd

- High quality micro switches for a wide range of applications
- Excellent performance, high reliability and long service life
- UL/cUL and ENEC certification
- Applications - Telephone, Air conditioner, Computer, Humidifier, Alarm, Time recorder, Mixer & Chopper, Solder gun, Neon phone, Fax machine, Joystick, Water pump, Gas detector, Pencil sharpener, Money sorter, Food processor, Electric knife, Toy car, Juice maker, Electric steak pan.



Reference dimensions mm

Unless otherwise specified, a tolerance of $\pm 0.4\text{mm}$ applies to all dimensions.

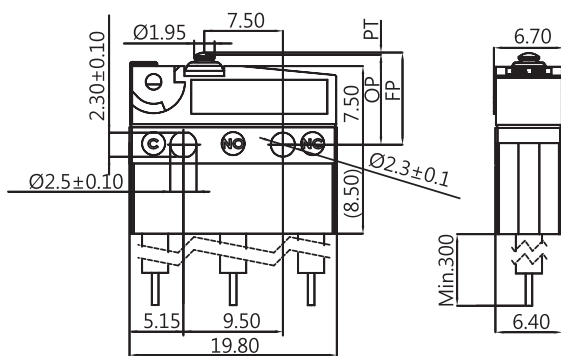

Certification information

Model Name	UL - cUL	ENEC
SW2-C1	0.1RA 125/250VAC uT125 1E4	0.1A 125/250VAC uT125 1E4
SW2-C3	3GPA 125/250VAC uT125 1E4	3A 125/250VAC uT125 1E4
SW2-06	5RA 30VDC uT125 1E4 6GPA 125/250VAC uT125 1E4	5A 30VDC uT125 1E4 6A 125/250VAC uT125 1E4
SW2-10	5RA 30VDC uT125 1E4 10RA125/250VAC uT125 1E4 10GPA 125/250VAC uT125 1E4	5A 30VDC uT125 1E4 10(2)A 125/250VAC uT125 1E4
SW2-H10	5RA 30VDC uT125 1E4 10RA125/250VAC uT125 1E4 10GPA 125/250VAC uT125 1E4 1/4HP 125/250VAC uT125 1E4	5A 30VDC uT125 1E4 10(2)A 125/250VAC uT125 1E4

Selection of rating & force

MODEL	Rating	L	S	H
SW2	0.1A	★	★	★
	3A	★	★	★
	6A	★	★	★
	10A 10(2)A		★	★
	1/4 hp 10A 10(2)A		★	★





NOTE: The symbol " ★ " represents the result is accepted

SW2-IP67 Series Micro Switches (WATERPROOF)

herga

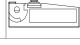
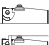
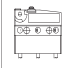
Technology Ltd

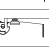
Ordering information

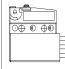
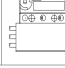
S	W	2	-	0	6	S	1	-	0	0	0	0	E	A	0		
SERIES PREFIX	CODE	RATING CURRENT	CODE	OPERATING FORCE	CODE	COVER TYPE	CODE	ACTUATOR TYPE	CODE	WIRE SIDE	CODE	CIRCUIT ARRANGEMENT	CODE	AWG TYPE	CODE	UL NUMBER	
C1	0.1A	125/250 VAC	H	HEAVIER	1		00		0		0	S.P.D.T	E	20	A	UL1007	
C3	3A	125/250 VAC	S	STANDARD			01					1	S.P.S.T NO	F	22	B	UL1015
06	6A	125/250 VAC	L	LIGHT			02					2	S.P.S.T NC	G	24	C	UL1430
10	10A	125/250 VAC					03							H	26	D	UL1061
	10(2)A	125/250 VAC							R							F	AV
	10A	125/250 VAC							L								
H10	10(2)A	125/250 VAC															
	1/4 hp	125/250 VAC															
#NOTE																	
	RATING CURRENT	AWG TYPE	LEADS WIRE	OPERATING FORCE													
1	Code:C1	20,22,24,26	Min.30cm	L, S, H													
	Code:C3	20,22,24,26	Min.30cm	L, S, H													
	Code:06	20,22	Min.30cm	L, S, H													
	Code:10	20	Min.30cm	S, H													
	Code:H10	20	Min.30cm	S, H													
2	UL number code:FAV wire(no safety).																